

# Gravity

## executive desk height adjustment

### Technical Data

- Worktop - 78 mm thick, veneer/HPL, max. load 70 kg;
- Sliding front - MDF, varnished 18 mm, soft-closing system;
- Drawer - 100% extension, self-closing, dimensions: 290 x 500 x 280 mm;
- Body - MDF lacquered 28 mm;
- Mediabox (option with extra charge) - M06 - 2x230V+USB charger, colour: white or black; M06H - 2x230V+HDMI+USB, colour: white or black;
- Modesty panel - chipboard 18 mm, veneer/HPL; fixing element - powder-coated metal;
- Control panel;
- Electric height adjustable frame - powder-coated steel, column dimension 150x150 mm, frame profile 60 x 30 mm;
- Shelf - MFC 18 mm, dimensions: 457 x 182 x 259 mm;
- Inside the cabinet: usable space; structural non-usable space - supporting structure + concrete blocks; lifting mechanism access;
- Desk, table and multimedia stand require a hard and unbendable surface with an acceptable point pressure of at least 300 kg/point to preserve stability;
- Made in Poland, EU

### Selected configuration

#### GAV1L

**Height:** 750 - 1160 mm

**Width:** 2400 mm

**Length:** 1600 mm

**Colour of the tabletop:** American walnut veneer

**Colour of the body:** Graphite matte RAL 9004

**Colour of the frame:** Anthracite semi-matt RAL 7043

**Type of plug:** EU plug

**Mediabox:** No mediabox

**Colour of mediabox / grommet:** Not applicable

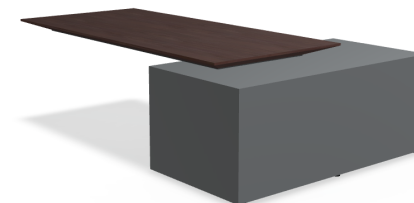

### Guarantee

.mdd products - 5 years.

Electrical components - 2 years.

### Assembly manuals



### Certificates



---

## Sustainability

- Wood-based materials used in the production of our furniture are acquired from FSC-certified producers.
  - Sustainable production – we are not indifferent to the environmental impact of our furniture, therefore we provide the essential information on the lifecycle of our products via the Environmental Product Declaration.
  - Metal bases (GAV19) are powder-coated to reduce the emission of Volatile Organic Compounds.
- 

## Material composition & packaging

- MFC: 89%
- HPL: 3%
- Steel: 4%
- Plastic: 1%
- Cardboard: 3%

\*average values for a representative of the group.

---

## Recycled content

4%

---

## Recyclability

- Recycling: 10%
- Downcycling: 90%

\*average values for a representative of the group.

---

## Packaging

Materials: cardboard + foil + wooden crate

Recyclability: 100%

---